

1 2 3 4 5 6

A

A

B

B

C

C

D

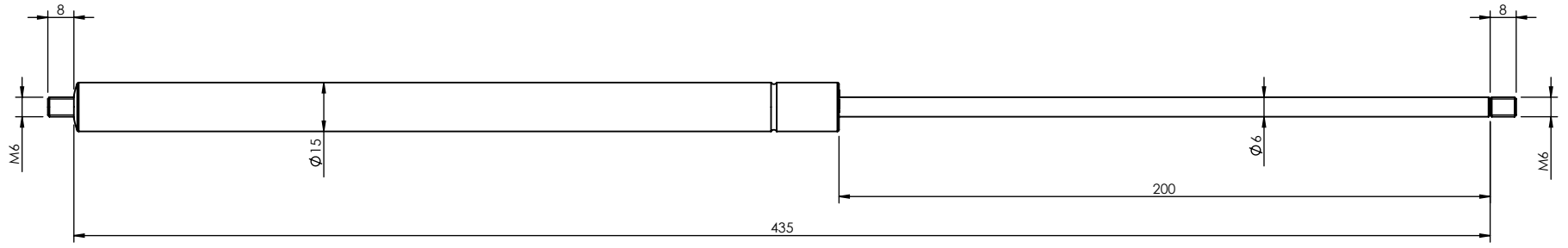
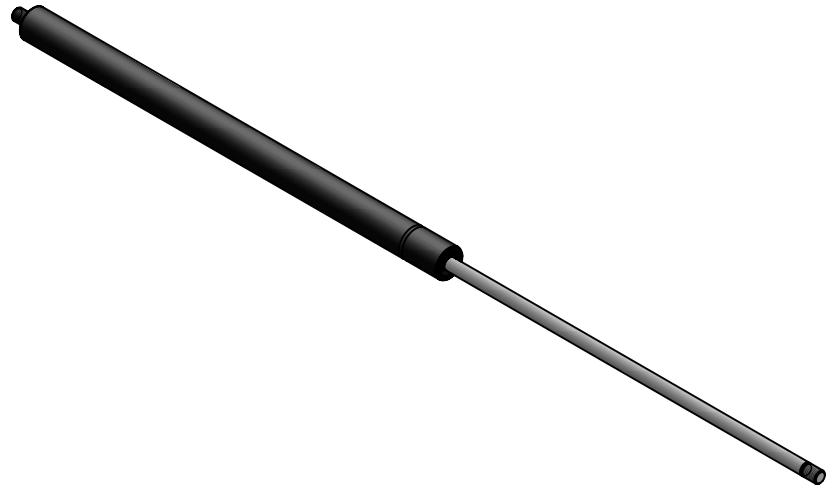

Unless otherwise specified: All dimensions are in millimeters & include chem. applied/plated finish. Remove Burrs & sharp edges.

CONFIDENTIAL: THIS DOCUMENT AND THE INFORMATION CONTAINED IN IT ARE CONFIDENTIAL, AND CANNOT BE COPIED OR DISCLOSED IN WHOLE OR IN PART WITHOUT THE EXPRESS WRITTEN CONSENT OF BRIMOTECH SOLUTIONS BY HOLLAND

Tolerance according to NEN-ISO 406
 Roughness according to NEN 3634
 Shape tolerance according to NEN-ISO 1101

Nominal size (mm)	dim variation (mm)
0 - 3	±0.05
3 - 6	±0.06
6 - 10	±0.08
10 - 15	±0.10
15 - 20	±0.12
20 - 30	±0.15
30 - 50	±0.20
50 - 100	±0.30
100 - 200	±0.50
200 - 500	±0.80
500 - 1000	±1.20
1000 - 2000	±2.00

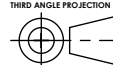

General tolerance on gas springs and dampers is 2mm

Brimotech solutions
 Brimotech Solutions BV
 Koperstraat 4 8211 AK Lelystad
 T: +31 (0)320 769103 F: +31 (0)84 8317577
 The Netherlands
 Info@brimotech.nl
 www.brimotech.nl

Part number: 10220019	Description: Gasspring stroke 200mm	Date last saved: 15-9-2017
Add. info: -	Material: Steel	Date created: 9-5-2012
Finish: RAL9005	Configuration: Open force [50N- 400N]	Weight: 166.05 Gram
Drawing: 10220019	F1 Force:N	DXF/STEP available on request
Revision:		Scale: 1:2

Size A4
 Drawn by: M. Brokkaar